

Description of the campsite and rental conditions for Mobilhome OHARA confort



1. Administrative information's :

Name and address of the campsite LES ULEZES route de Romans 26260 SAINT DONAT SUR HERBASSE, FRANCE

Phone number: +33 (0)4 75 47 83 20

Mail address : contact@domaine-des-ulezes.com

Website : <http://www.french-camping-drome.com>

Data of the opening period : April, 1 – October, 31

Hours of arrival and departure: 14 hours – 12 hours

Category (number of stars) : 4 (AP N° 2011284-0004 from October, 11-2011)

Tourism classification : 76 pitches

Holiday classification : 9 pitches

SIRET (company registration) number 804 683 670 00017

GPS coordinates: lat 45.1192 long 4.9927

2. General information's

Geographical situation of the campsite :

Distance of the nearest river : 10 metres

Distance of the nearest town or village: 600 metres

Distance of the nearest railway station : 12 km (Romans)

Distance of the nearest bus station : 12 km (Romans)

Distance of the nearest food shop : 600 metres

Between Romans and Tain l'Hermitage, the commune of Saint Donat sur l'herbasse, in the Drôme des collines, welcomes you. You'll find here a lot of shops, a medical practice, dental practices, and a very nice old town with its church that you can visit and where you can be present at concerts. Saint Donat is ideally situated between mountains of the Vercors and the mountains of the Ardèche.

Bus services assure the transfers between Saint Donat and Romans or Valence.

(<http://buscars26.free.fr/horaires.html>)

General, on the campsite located facilities: Washing machine, dryer, ironing room, phone point, swimming pool, playground for children, mini golf, table tennis table, sports terrain, games room and TV room, free library, snack bar, internet point, Wi-Fi

3. Descriptive of the rented accommodation : OHARA 784 4 persons

Map of the mobil home

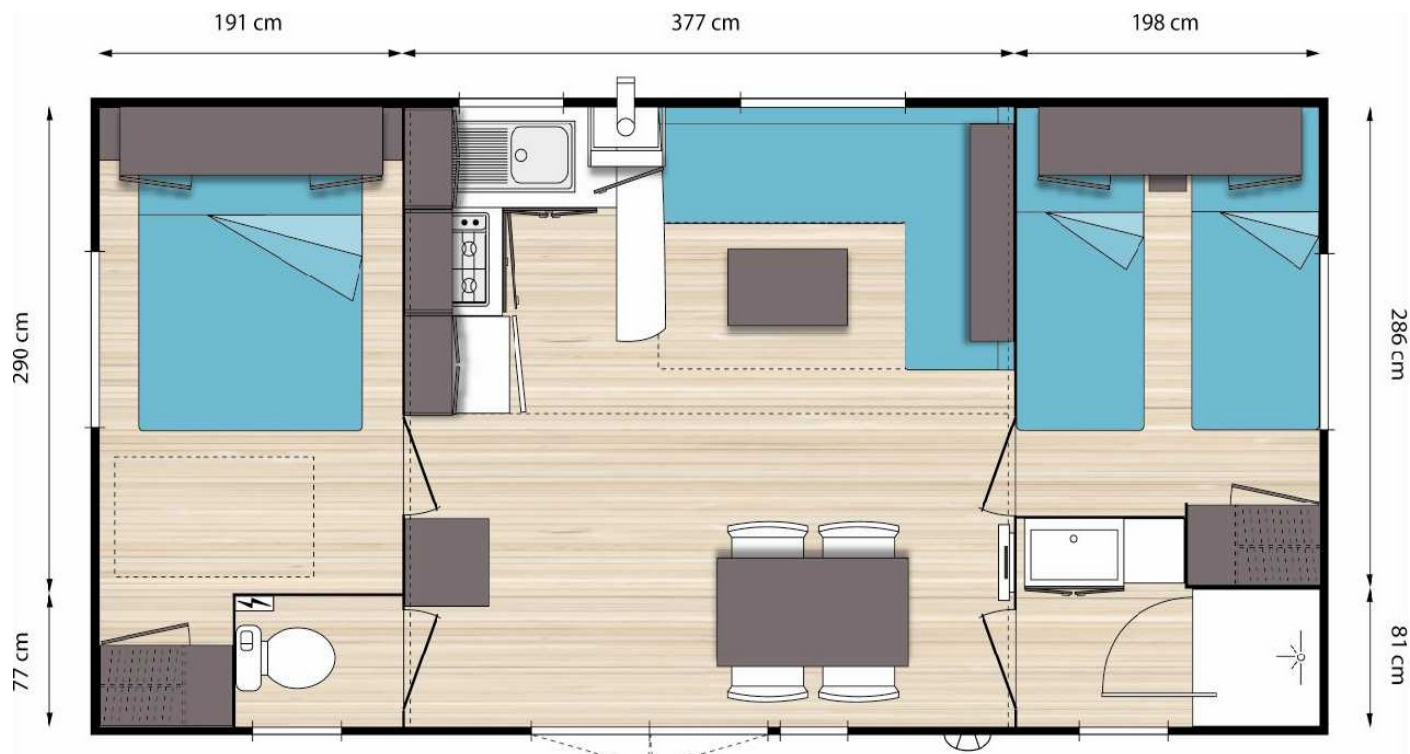

Type of accommodation : **OHARA 784 4 pitches « confort »**

Age of the accommodation: 2009

Surface of the accommodation (exclusive the terrace) : 32 m² covered terrace 12 m²

Maximum number of persons: 6 Accommodation not accessible for disabled persons.

Descriptive inside

1st room :

2 beds for one person with mattress, mattress cover, pillows and blanket.

1 bedside table, a closet, a mural storage.

2nd room :

1 bed for two persons with mattress, mattress cover, pillows and blanket.

2 bedside tables, a closet, a mural storage.

Possibility to buy disposable sheets at the reception.

Living room : a sofa, a table, 4 chairs.

Kitchen : 1 Gas hob with 4 burners, 1 microwave oven, 1 fridge freezer, 1 cooking utensils and crockery for 6 persons (see inventory), an electric coffee maker, a toaster and a storage closet. A garden table, a deckchair and 6 chairs complete the furniture.

The accessories and cleaning supplies are provided.

Sanitary facilities: a separate WC and a bathroom with shower and wash basin.

Heating : an electric radiator in every room (except WC).

Internet : available.

Inventory

The inventory must be controlled at your arrival and any anomaly must be reported at the reception.

| Inventaire MOBILHOME 49 confort | | | |
|---|----------------------|------------------------------|----|
| français | anglais | néerlandais | |
| assiettes | plates | borden | 8 |
| assiettes creuses | soup plates | diepe borden | 6 |
| petites assiettes | small plates | kleine borden | 8 |
| saladier | salad bowl | schaal | 2 |
| plat creux | hollow dish | diep bord | 1 |
| plat inox | inox dish | inox bord | 1 |
| bols | bowls | kommen | 6 |
| tasses/sous tasses | cups | kopjes/schoteltjes | 6 |
| verres 25 cl | glasses 25cl | glazen 25 cl | 6 |
| cafetière électrique | electric coffeemaker | elektrisch koffiezetapparaat | 1 |
| verres 33cl | glasses 33cl | glazen 33 cl | 6 |
| pichet | jug | karaf | 1 |
| casserolles | pans | pannen | 3 |
| poêle | stove | koekepan | 2 |
| fait tout et couvercle | fact all and lids | grote pan en deksels | 1 |
| passoire | strainer | zeef | 1 |
| plat à four | oven dish | ovenschaal | 1 |
| couvercle | cover | deksel | 2 |
| couteaux | knives | messen | 10 |
| cuilleres | spoons | lepels | 8 |
| fourchettes | forks | vorken | 8 |
| petites cuilleres | small spoons | lepeltjes | 8 |
| couverts à salade | covers with salade | sla bestek | 1 |
| rape | rape | verkrachting | 1 |
| cuillère bois | wooden spoon | houten lepel | 1 |
| plateau | shelf | shelf | 1 |
| théière | teapot | theepot | 1 |
| gobelet gradué | measuring cup | maatbeker | 1 |
| louche | big spoons | soeplepel | 1 |
| écumoire | skimmer | schuimspaan | 1 |
| spatule | spatula | spatel | 1 |
| bac glaçons | ice cubes | ijsklontjes | 1 |
| couteau à découper | carving knife | snijmes | 1 |
| grille pain | toaster | broodrooster | 1 |
| ouvre boite | bin | blikopener | 1 |
| ouvre bouteille | open bottle | flesopener | 1 |
| couteau à pain | breadknife | broodmes | 1 |
| économome | potato peeler | aardappelschil mesje | 1 |
| essoreuse à salade | salad dryer | salade droger | 1 |
| planche à découper | cutting board | snijplank | 1 |
| dessous de plat | Coasters | onderzetter | 1 |
| seau | bucket | emmer | 1 |
| serpillère | mop | dweil | 1 |
| pelle | shovel | stoffer | 1 |
| balai | soft broom | bezem | 1 |
| balai brosse | hard broom | shrobber | 1 |
| poubelle | dustbin | vuilnisbak | 2 |
| cendrier | ashtray | asbak | 1 |
| couvertures | blankets | dekens | 4 |
| alèzes | mattress protectors | Matrasbeschermers | 3 |
| oreillers | pillows | hoofdkussens | 6 |
| cintres | clothes hangers | hangertjes | 8 |
| séchoir à linge | drier | droger | 1 |
| paillason | doormat | deurmat | 1 |
| décrottoir | mud-scraper | schraper | 1 |
| tapis de bain | carpet of bath | badmat | 1 |
| brosse WC | toilet brush | WC borstel | 1 |
| dérouleur papier WC | toilet paper roller | WC rolhouder | 1 |
| micro-ondes | microwave | magnetron | 1 |
| pincettes à linge | clothes pins | wasknijpers | |
| bassine | tub | teil | 1 |
| Inventaire à contrôler à l'arrivée - Signaler toute anomalie à l'accueil Tout ustensile cassé ou détérioré devra être remplacé ou remboursé Draps jetables en vente à l'accueil | | | |

4. Prices and modalities of the accommodation

Price of the accommodation:

one night during low season : 80 €

one night during high season (July/August) : 110 €

one week during low season: 400 €

one week during high season (July/August) : 610 €

These prices don't include our seasonal promotions, to profit of them, visit the "promotions" page on our website.

The amount of the local tax : 0,40 € per person of more than 13 years and per day (for information)

The amount of the advances : 50 % of the total amount (exclusive local tax)

Conditions of payment: at the starting of your stay, when handing over the keys.

Booking fee: free

Third-party liability insurance required.

It's forbidden to smoke in the rentals.

5. Prices of the additional rent services and the other services

Additional, not included in the rental price services:

- Cleaning : 50 € (if not done by you)
- Bedding : 5 to 7 € for disposable sheets
- Supplement for extra vehicle: 5 € per day

**6. Rental conditions : to read attentively and to return signed to the campsite
LES ULEZES route de Romans 26260 SAINT DONAT SUR HERBASSE**

The hire becomes only effective after our agreement, subject to availability, and after the receipt of a payment of 50% deposit of the total amount of rent and of this present contract signed.

A mobilhome cannot be occupied by a number of persons more than that for which it was designed, pets are allowed (5 € per day).

The rental price includes the persons, one car, the electricity and gas. It does not include the sheets, bedding, visitors, extra cars, the cleaning and local tax.

If you have to give up your stay, the cancellation should be notified by post or mail to us, the date of receipt will be the date of cancellation. Cancellation fee : you will have to pay

- 50% if you cancel more than 30 days before your date of arrival
- 100% if you cancel less than 31 days before your date of arrival or if you don't come at this date.

The reception is possible after 15 h the first day and the rental would be free before 11 h the last day. The full amount of stay is payable on the arrival day. No reduction may be granted in the case of a late arrival or advanced departure.

A deposit of 200 Euros must be paid at the campsite reception as well as 50 Euros for cleaning the rental, if it needs to be cleaned by us. At your arrival and on the day of your departure, an inventory is made by the campsite manager with your presence during our opening hours. During your stay, the maintenance of the rental is depending on you and you must return it clean and tidy. The deposit will be returned at the end of your stay after deduction of missing items and damage.

All customers are required to comply with the rules of the campsite, posted up at the reception. All customers must have insurances for their property and their family.

Signature customer preceded by the mention "read and approved"

Request for reservation for renting mobilhome OHARA 784 :

NAME First name : _____

Address : _____

Phone : _____ Number of adults : _____ Number of children (-13 years) : _____

Date of arrival : _____ Date of departure : _____

Price of the stay _____ € local tax _____ €

Payment of an advance of 50% of the total price, that's to say _____ € by :

- cheque
- bank transfer (contact us)
- species*

* scratch as appropriate