

Description of the campsite and rental conditions for Mobilhome OHARA 784 6 persons

1. Administrative information's :

Name and address of the campsite LES ULEZES route de
Romans 26260 SAINT DONAT SUR HERBASSE, FRANCE
one number: +33 (0)4 75 47 83 20
Mail address : contact@domaine-des-ulezes.com



Website : <http://www.french-camping-drome.com>

Data of the opening period : April, 1 – October, 31
Hours of arrival and departure: 15 hours – 11 hours
Category (number of stars) : 4 (AP N° 2011284-0004 from October, 11- 2011)
Tourism classification : 76 pitches
Holiday classification : 9 pitches

SIRET (company registration) number: 804 683 670 00017
GPS coordinates: lat 45.1192 long 4.9927

2. General information's

Geographical situation of the campsite :

Distance of the nearest river : 10 metres
Distance of the nearest town or village: 600 metres
Distance of the nearest railway station : 12 km (Romans)
Distance of the nearest bus station : 12 km (Romans)
Distance of the nearest food shop : 600 metres

Between Romans and Tain l'Hermitage, the commune of Saint Donat sur l'herbasse, in the Drôme des collines, welcomes you. You'll find here a lot of shops, a medical practice, dental practices, and a very nice old town with its church that you can visit and where you can be present at concerts. Saint Donat is ideally situated between mountains of the Vercors and the mountains of the Ardèche.

Bus services assure the transfers between Saint Donat and Romans or Valence.
(<http://buscars26.free.fr/horaires.html>)

General, on the campsite located facilities: Washing machine, dryer, ironing room, phone point, swimming pool, playground for children, mini golf, table tennis table, sports terrain, games room and TV room, free library, snack bar, internet point, Wi-Fi

3. Descriptive of the rented accommodation : OHARA 784 6 persons

Map of the mobil home

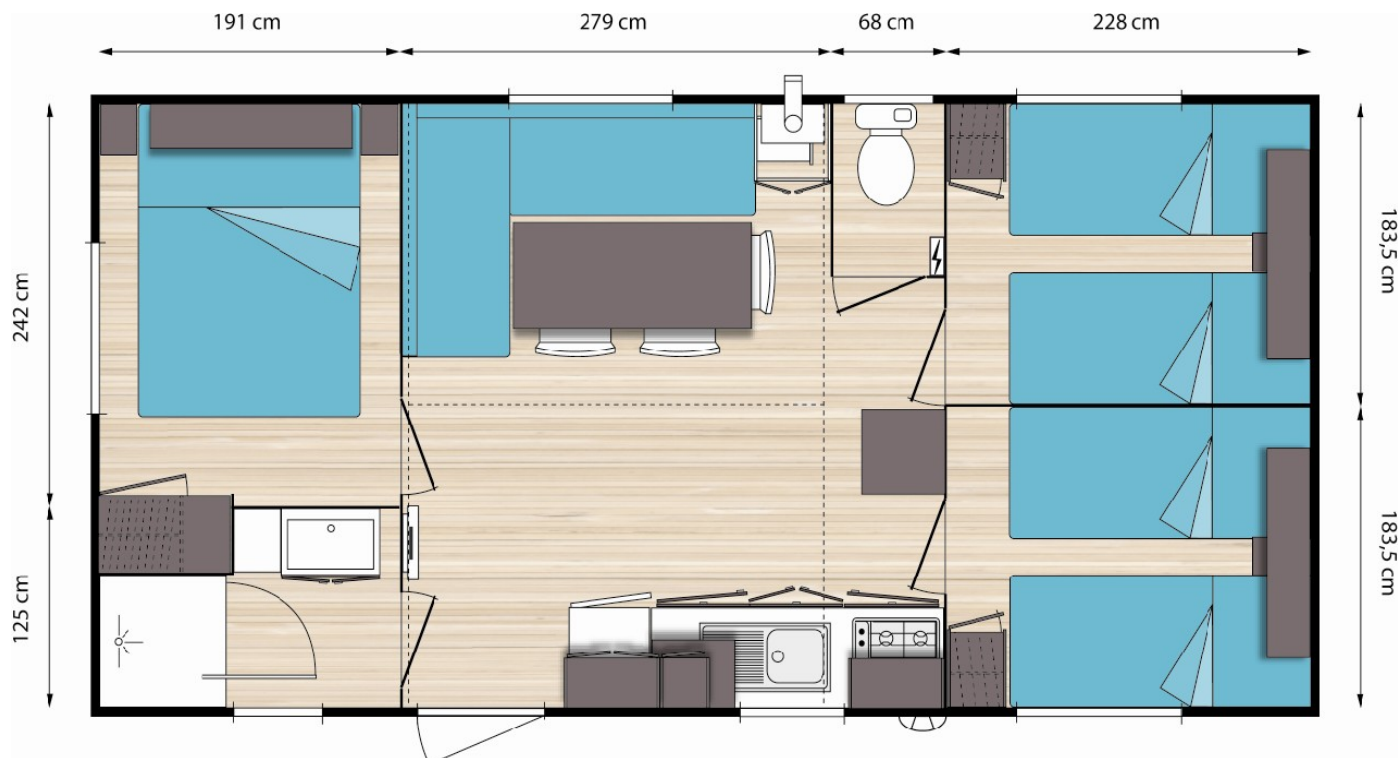

Type of the accommodation : **OHARA 784 6 persons**

Age of the accommodation: 2009

Surface of the accommodation (exclusive the terrace) : 32 m² covered terrace 12 m²

Maximum number of persons: 6

Accommodation not accessible for disabled persons.

Descriptive inside

1st room :

2 beds for one person with mattress, mattress cover, pillow and blanket.

1 bedside table, a closet, a shelf.

2nd room :

2 beds for one person with mattress, mattress cover, pillow and blanket.

1 bedside table, a closet, a shelf.

3rd room :

1 bed for two persons with mattress, mattress cover, pillow and blanket.

1 bedside table with a bed light, a closet, a shelf.

Possibility to buy disposable sheets at the reception.

Living room : a sofa, a table, 3 chairs and a closet storage.

Kitchen : 1 Gas hob with 4 burners, 1 microwave oven, 1 fridge, 1 cooking utensils and crockery for 6 persons (see inventory), an electric coffee maker and a toaster. A garden table, a deckchair and 6 chairs complete the furniture.

The accessories and cleaning supplies are provided.

Sanitary facilities: a separate WC and a bathroom with shower and a wash basin.

Heating : an electric radiator in all the room except WC.

Internet : available.

Inventory:

The inventory must be controlled at your arrival and any anomaly must be reported at the reception.

Inventaire MOBILHOME 6 pers			
français	anglais	néerlandais	
assiettes	plates	borden	8
assiettes creuses	soup plates	diepe borden	6
petites assiettes	small plates	kleine borden	8
saladier	salad bowl	schaal	2
plat creux	hollow dish	diep bord	1
bols	bowls	kommen	6
tasses/sous tasses	cups	kopjes/schoteltjes	6
verres 25 cl	glasses 25cl	glazen 25 cl	6
cafetière électrique	electric coffeemaker	elektrisch koffiezetapparaat	1
verres 16cl	glasses 16cl	Glazen 16 cl	6
plat inox	inox dish	inox bord	1
pichet	jug	karaf	1
casseroles	pans	pannen	3
poêle	stove	koekepan	2
fait tout et couvercle	fact all and lids	grote pan en deksels	1
passoire	strainer	zeef	1
plat à four	oven dish	ovenschaal	1
couvercle	cover	deksel	2
rape	grater	rasp	1
couteaux	knives	messen	10
cuilleres	spoons	lepels	8
fourchettes	forks	vorken	8
petites cuilleres	small spoons	lepeltjes	8
couverts à salade	covers with salade	sla bestek	1
louche	big spoons	soeplepel	1
écumoire	skimmer	schuimspaan	1
spatule	spatula	spatel	1
cuillère bois	wooden spoon	houten lepel	1
bac glaçons	ice cubes	ijsklontjes	1
couteau à découper	carving knife	snijmes	1
grille pain	toaster	broodrooster	1
ouvre boîte	bin	blikopener	1
ouvre bouteille	open bottle	flesopener	1
couteau à pain	breadknife	broodmes	1
économiseur	potato peeler	aardappelschil mesje	1
essoreuse à salade	salad dryer	salade droger	1
planche à découper	cutting board	snijplank	1
boîte plastique	plastic box	plastic box	1
gobelet gradué	measuring cup	maatbeker	1
plateau	shelf	shelf	1
dessous de plat	Coasters	onderzetter	1
seau	bucket	emmer	1
serpillère	mop	dweil	1
pelle et balayette	shovel	stoffer	1
balai	soft broom	bezem	1
balai brosse	hard broom	shrobber	1
poubelle	dustbin	vuilnisbak	2
cendrier	ashtray	asbak	1
couvertures	blankets	dekens	5
alèzes	mattress protectors	Matrasbeschermers	5
oreillers	pillows	hoofdkussens	6
cintres	clothes hangers	hangertjes	8
séchoir à linge	drier	droger	1
paillason	doormat	deurmat	1
décrottoir	mud-scraper	schraper	1
tapis de bain	carpet of bath	badmat	1
brosse WC	toilet brush	WC borstel	1
dérouleur papier WC	toilet paper roller	WC rolhouder	1
micro-ondes	microwave	magnetron	1
pinces à linge	clothes pins	wasknijpers	
bassine	tub	teil	1
Inventaire à contrôler à l'arrivée - Signaler toute anomalie à l'accueil Tout ustensile cassé ou détérioré devra être remplacé ou remboursé Draps jetables en vente à l'accueil			

4. Prices and modalities of the accommodation

Price of the accommodation:

one night during low season : 95 €

one night during high season (July/August) : 130 €

one week during low season: 480 €

one week during high season (July/August) : 700 €

These prices don't include our seasonal promotions, to profit of them, visit the "promotions" page on our website.

The amount of the local tax : 0,40 € per person of more than 18 years and per day (for information)

The amount of the advances : 50 % of the total amount (exclusive local tax)

Conditions of payment: at the starting of your stay, when handing over the keys.

Booking fee: free

Third-party liability insurance required.

It's forbidden to smoke in the rentals.

5. Prices of the additional rent services and the other services

Additional, not included in the rental price services:

- Cleaning : 50 € (if not done by you)
- Bedding : 5 to 8,50 € for disposable sheets
- Supplement for extra vehicle: 5 € per day

**6. Rental conditions : to read attentively and to return signed to the campsite
LES ULEZES route de Romans 26260 SAINT DONAT SUR HERBASSE**

The hire becomes only effective after our agreement, subject to availability, and after the receipt of a payment of 50% deposit of the total amount of rent and of this present contract signed.

A mobilhome cannot be occupied by a number of persons more than that for which it was designed, pets are allowed (5 € per day).

The rental price includes the persons, one car, the electricity and gas. It does not include the sheets, bedding, visitors, extra cars, the cleaning and local tax.

If you have to give up your stay, the cancellation should be notified by post or mail to us, the date of receipt will be the date of cancellation. Cancellation fee : you will have to pay

- 50% if you cancel more than 30 days before your date of arrival
- 100% if you cancel less than 31 days before your date of arrival or if you don't come at this date.

The reception is possible after 15 h the first day and the rental would be free before 11 h the last day. The full amount of stay is payable on the arrival day. No reduction may be granted in the case of a late arrival or advanced departure.

A deposit of 500 Euros must be paid at the campsite reception as well as 50 Euros for cleaning the rental, if it needs to be cleaned by us. At your arrival and on the day of your departure, an inventory is made by the campsite manager with your presence during our opening hours. During your stay, the maintenance of the rental is depending on you and you must return it clean and tidy. The deposit will be returned at the end of your stay after deduction of missing items and damage.

All customers are required to comply with the rules of the campsite, posted up at the reception. All customers must have insurances for their property and their family.

Signature customer preceded by the mention "**read and approved**"

Request for reservation for renting mobilhome OHARA :

NAME First name : _____

Address : _____

Phone : _____ Number of adults : _____ Number of children (-18 years) : _____

Date of arrival : _____ Date of departure : _____

Price of the stay _____ € local tax _____ €

Payment of an advance of 50% of the total price, that's to say _____ € by :

- cheque
- bank transfer (contact us)
- species *

* scratch as appropriate